

TORRANCE ALUMINUM

ALUMINUM WINDOW and DOOR SYSTEMS

3000 Series Windows

- *Polyamide 66 Thermal Struts*
- *3" Window Framing*
- *AW100 Rating*
- *Up to .28 U-Value (Title 24) with various glass options*
- *Up to STC 44 Rating*



Window Types

- *Fixed Windows*
- *Casement Ventilators*
- *Awning Ventilators*
- *Hopper Ventilators*
- *Combination Windows*
- *Shaped Windows*

Window Framing

- *Equal Leg (Block Frame)*
- *Short Equal Leg*
- *Unequal Leg*
- *Nail-Fin*
- *Recessed Nail-Fin*
- *Compensating Channel*
- *Comp. Channel w/ Nail-Fin*
- *Panning System*

3000 SERIES (THERMAL-BREAK WINDOWS)

Casement, Awning, Hopper, Fixed or Combination Windows

Equal Leg, Short Equal Leg, Long Leg, Standard Nail-Fin or Recessed Nail-Fin Framing

Insulated or Single Glazing — Rectangular or Sloped Glazing Beads

True or Simulated Muntins — Insect Screens with Aluminum Wire or Fiberglass Mesh

Ball Guard Screens — Receptors, Panning & Interior Trim — Sub-sill & Sill Covers

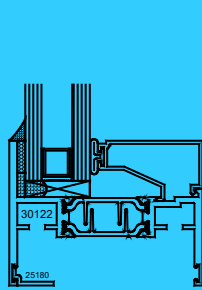

EQUAL LEG FRAME
FIXED WINDOW

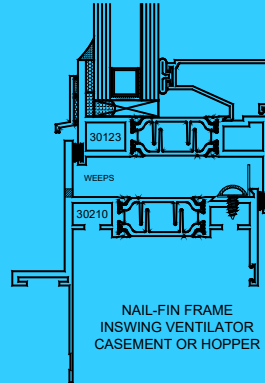

NAIL-FIN FRAME
INSWING VENTILATOR
CASEMENT OR HOPPER

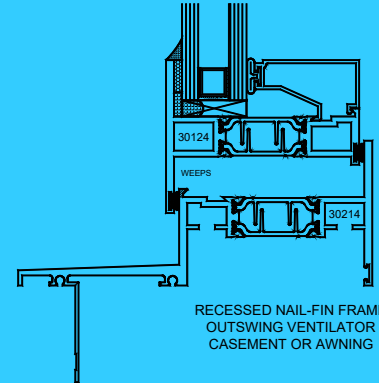

RECESSED NAIL-FIN FRAME
OUTSWING VENTILATOR
CASEMENT OR AWNING

Muntin Options:

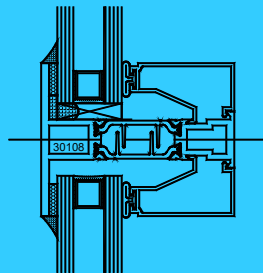

2 3/8" MUNTIN
(True Divided Light)

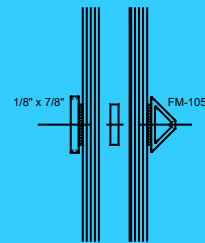

7/8" FALSE MUNTIN
(Simulated Divided Light)

NOTE: 1" Insulated glass units are shown. Other glass thicknesses are available.

Many other framing sections are also available. Standard, ADA and specialized

window hardware can be furnished. Consult TAW with all of your requirements

3000 SERIES WINDOW PERFORMANCE TABLE

<u>RATING</u>	<u>CONFIGURATION</u>	<u>AIR</u>	<u>WATER</u>	<u>STRUCTURAL</u>	<u>U-VALUE</u>	<u>STC Rating</u>
AW100	PROJECT-OUT/CSMT	6.24 psf	15.0 psf	150 psf (242 mph)	0.38	44
AW100	PROJECT-IN	6.24 psf	12.0 psf	150 psf (242 mph)	0.37	44
AW100	FIXED	6.24 psf	15.0 psf	150 psf (242 mph)	0.28	44

Note: U-Values and STC Rating are Glass Dependent!



3000 Series Specifications:

General: Windows are thermally-broken Series 3000 as manufactured by Torrance Aluminum. They Include hardware and related items as described and shown on the approved Shop Drawings.

Material: Aluminum used is heavy commercial quality extruded aluminum 6063-T5 alloy with an internal polyamide 66 strut thermal barrier. Windows are designed for inside or outside glazing using snap-in aluminum extruded bead.

Construction: All ventilator corners shall be mitered and reinforced with extruded keys that are crimped into place. All joints are sealed weathertight. Corners of frame are closely fitted, butt-jointed and tightly joined by mechanical means. Ventilator sections will be double weather-stripped, with EPDM sponge neoprene seals keyed into extruded grooves.

Glazing: At frames and ventilators, glazing legs are 7/8" high. Glazing beads are extruded, snap-in type, no less than .050" thick and accommodate up to and including 1 1/2" glass, panels or louvers.

Finish: Class I Anodizing or Kynar 500 paint, Electrostatically applied with a minimum of 70% Fluoropolymer Resin, Class I. Matching special colors in Kynar 500 are available.

Hardware: Torrance Aluminum's standard locking hardware and hinges are securely fastened to the frame and ventilator. Standard locking hardware consists of cam locking handles cast of white bronze, and secured with stainless steel screws. Mechanical operators, motorized operators, ADA and other non-standard hardware are available.

Screens: Optional insect screens of extruded aluminum frames, securely joined at corners and finished to match window frames. Standard screen cloth is 18 x 16 fiberglass mesh. Standard wickets and attachment clips are provided as required.

Thermal Barrier: The thermal barrier consists of (2) polyamide 66 struts. This barrier provides a continuous, uninterrupted thermal-break around the entire perimeter of frames and ventilators; and is not bridged by any metals, conductors or other materials.

Options: Compensating Channels, Sub-sills, Sill Covers, Panning, Interior Trim, Ball Guard Screens and Strap Anchors are available.

Installation: Window frames must be installed plumb, level and true without springing or twisting, and be securely fastened in place in accordance with the approved Shop Drawings and applicable building codes. Windows are to be caulked with a suitable compound; using appropriate joint design to accomplish a thoroughly water-tight installation as per the approved Shop Drawing details. Please note that Architectural waterproofing instructions would take precedence.

TORRANCE ALUMINUM

3000 Series Special Systems

Recessed Comp. Channel and Subsill

Standard Comp. Channel also available.

Both with or without nail-fin.

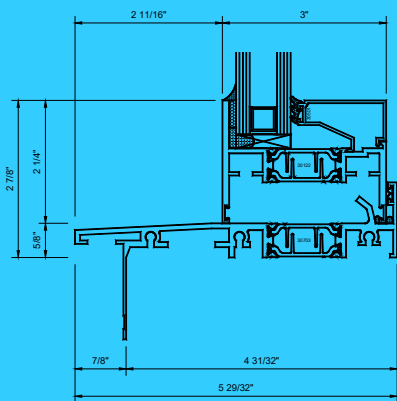
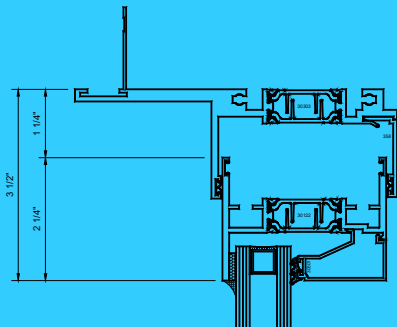

Panning and Trim System

Other sizes are also available.

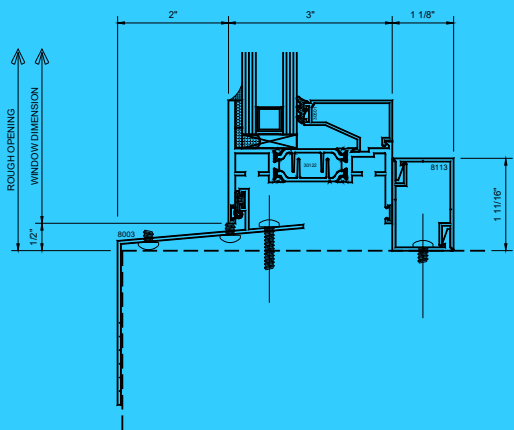
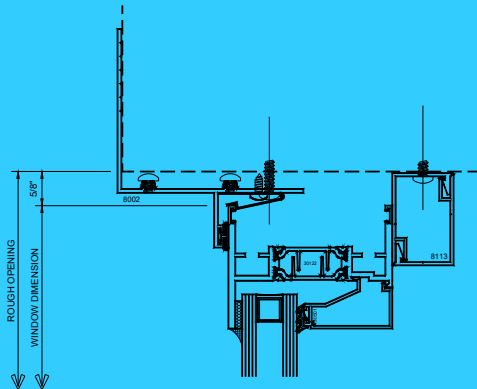

**If you need specific or non-standard
CAD drawings for your project,
please contact our Engineering Department**

TORRANCE ALUMINUM

3087 12TH STREET
RIVERSIDE, CA 92507

Phone (951) 783-9302
FAX (951) 783-9031

www.TorranceAluminum.com

email: info@TorranceAluminum.com



A division of Stylex Windows and Doors